

COMMITTEE 2017

| | | |
|----|----------|-------------|
| 1 | Nola | Cavanagh |
| 2 | Liz | Cruickshank |
| 3 | Dave | Duston |
| 4 | Michael | Fenton |
| 5 | Isabel | Hopkins |
| 6 | Flemming | Jensen |
| 7 | David | Karran |
| 8 | Brian | Lucy |
| 9 | Jean | Mcllwrick |
| 10 | Daniel | Phillips |
| 11 | Robyn | Savage |
| 12 | Jennifer | Sinclair |
| 13 | Leila | Stokes |

| | |
|--------|----------------|
| 4 & 12 | Co Presidents |
| 10 | Vice President |
| 1 | Secretary |
| 5 | Treasurer |

As of now why not accept the challenge and register for those series you think you won't like as well as those you know you will.

Get your brochure by Email at
dphillip@es.co.nz
 or go to our website:
www.u3ainvercargill.nz

Fractal

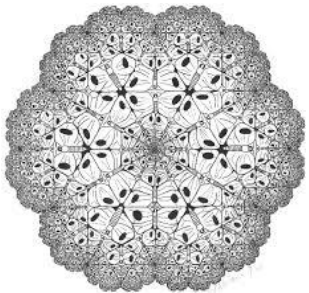

Lace

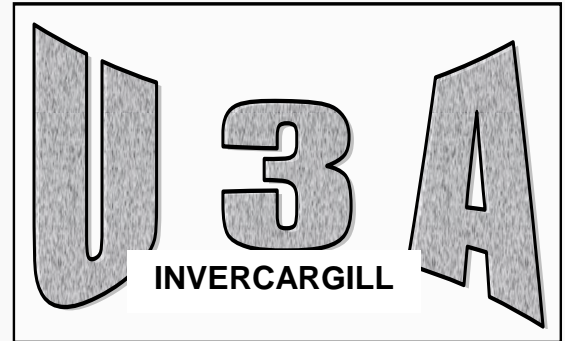

Dr Patrick Shepherd
Guest Speaker
Artists on Ice
and
End of Year Lunch

17 November 2017

Ice Crystal



**Venue: Windsor Community
Church Hall Windsor St.
Time: 10 a.m. and then 10.30am
Cost: \$10 per person - Lunch**

Friday November 10 at 10 a.m.

**Presenter: Claire Lenihan
The Road Less
Travelled.....**

From Invercargill to elsewhere and back.
Claire will talk to us about Environmental
Law, Music and Italy during her journey
on a road less travelled.

**Final Session for 2017
Friday November 17
at 10.30am**

**Dr Patrick Shepherd
Guest Speaker
Artists on Ice
Exploring the Arts in Antarctica**

Patrick spoke to us in Series 2 back in
April. He moved here from the UK in 1991.
He is an accomplished composer,
conductor performer and teacher. He has
conducted the Chch Symphony orchestra
and Chch Youth orchestra amongst many
others and is a music critic for The Press.
He has delivered promotional talks and
lectures on NZ music here and
internationally.

End of Year Lunch

12 noon approximately

A varied selection of finger food,
served with juice or soft drinks.
Tea and coffee will follow.

Please Note

**The charge of \$10 applies to the
lunch only.**

***Both presentations are free of
charge.***

If you intend to come to the lunch
you must register with the
Treasurer by
Wednesday 8th November.

If you have any special dietary
requirements, please tell
Jean McIlwrick 218 6109

Registration Form

Please enrol the person(s)
named on the reverse.

for

End of Year Series 8 2017

Amount enclosed
\$10 per person - Lunch

| Amount | Cash | Cheque |
|--------|------|--------|
| \$ | | |

**Make direct credit payments to
03 1746 0080910 000
using your name, series and
telephone numbers.
Registration form not required.**

**Please Post your registration to:
The Treasurer,
U3A Invercargill
P O Box 6147
Invercargill North
Invercargill 9841**

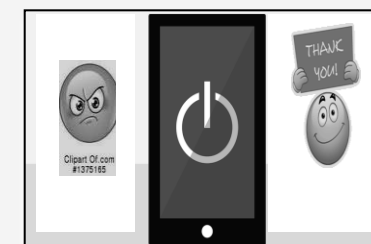

Daniel